

BizLink

TYPE 3015

Plug for safety class I

2-pole plug with earthing-contact, angled

SI 32 Part 1.1

16 A, 250 V~



Technical drawing

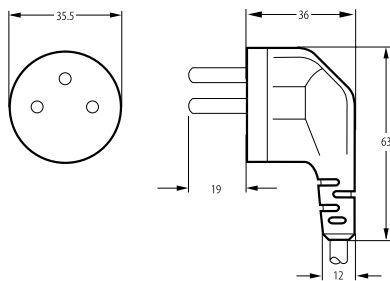

Approvals

Suitable flexible cord types

H03VV-F	3 G 0.75	H05VV-F	3 G 0.75
H05VV-F	3 G 1	H05VV-F	3 G 1.5