

BizLink

TYPE 229/1

Plug for safety class II

2-pole plug for heavy power tools

IEC 60884-1, SS XVII-CEE 7

16 A, 250 V~

solid metal pins, nickel-plated



Technical drawing

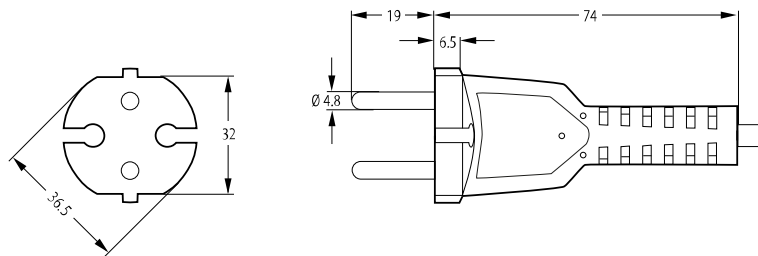

Approvals



Suitable flexible cord types

H07RN-F	2 x 1	H07RN-F	2 x 1.5
H07BQ-F	2 x 1	H07BQ-F	2 x 1.5